

R95-101



8-Pin Octal Socket

Features

- Panel/Surface Mount
- Pressure Clamp Screws
- Screws: 6-32 x 5/16", Steel, Nickel Plated.

Electrical Rating:

300 Volts, 15 Amps

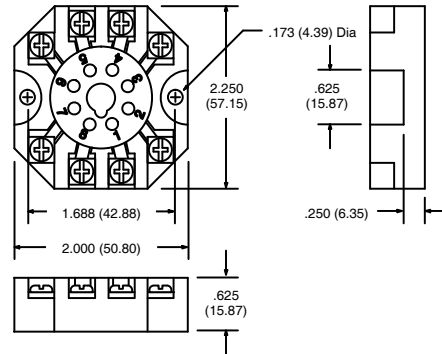
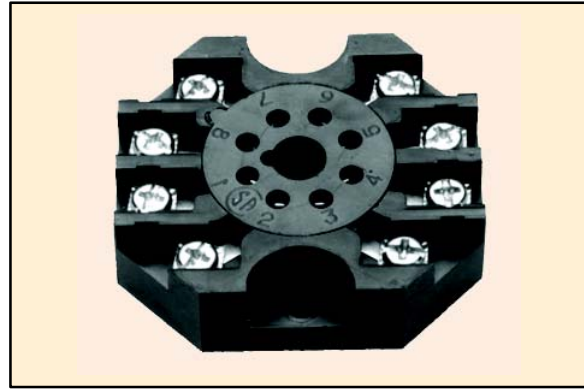

R95-102

10-Pin Blade Socket

Features

- PC Board Mount

Electrical Rating:

1000 Volts, 5 Amps

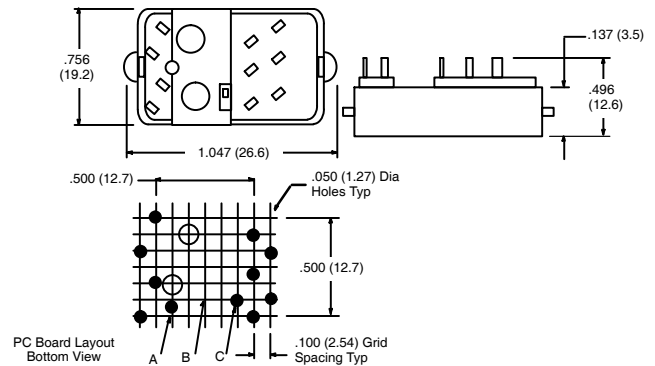

R95-103

10-Pin Blade Socket

Features

- Panel Mount
- Solder Terminals

Electrical Rating:

1000 Volts, 5 Amps

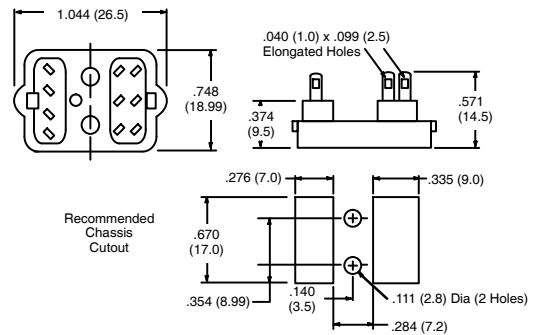
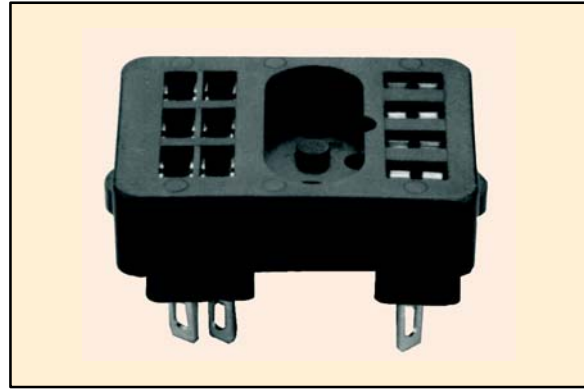

R95-104



11-Pin Octal Socket

Features

- Panel/Surface Mount
- Pressure Clamp Screws
- Screws: 6-32 x 5/16", Steel, Nickel Plated.

Electrical Rating:

300 Volts, 10 Amps

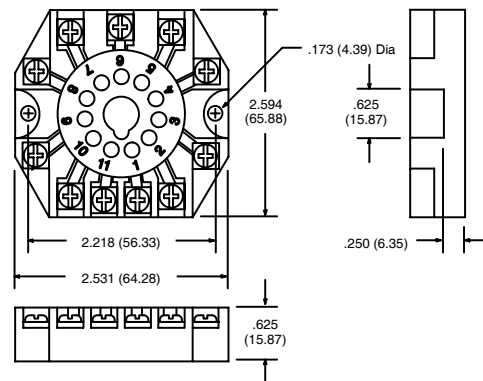

R95-113



8-Pin Octal Socket

Features

- Panel/Surface Mount
- DIN Rail Mountable
- Pressure Clamp Screws

Electrical Rating:

300 Volts, 10 Amps

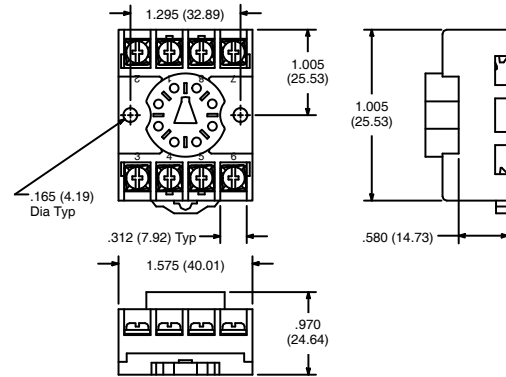
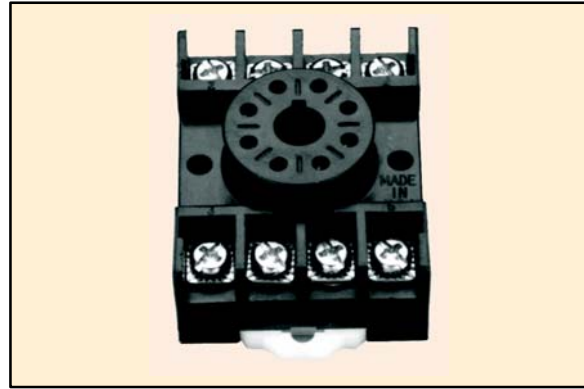

R95-114



11-Pin Octal Socket

Features

- Panel/Surface Mount
- DIN Rail Mountable
- Pressure Clamp Screws

Electrical Rating:

300 Volts, 10 Amps

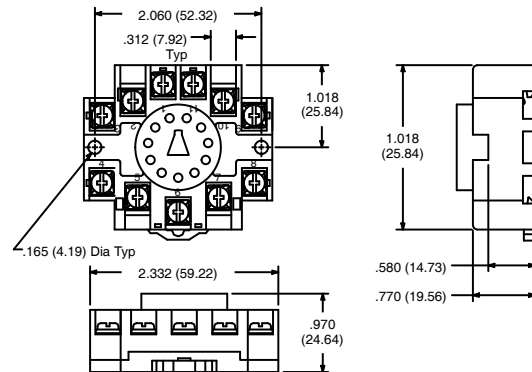
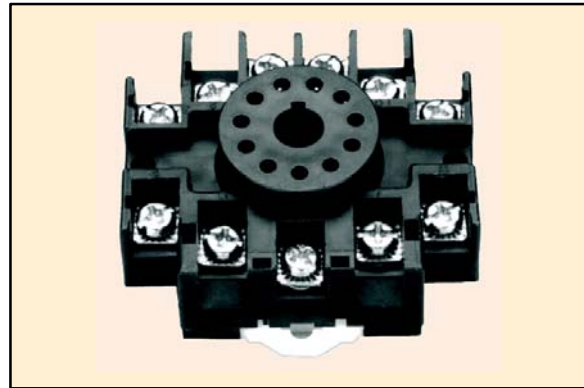

R95-180A

14-Pin Heavy Duty Socket

Features

- Surface Mount
- With Pressure Clamp Screws

Electrical Rating:

300 Volts, 10 Amps

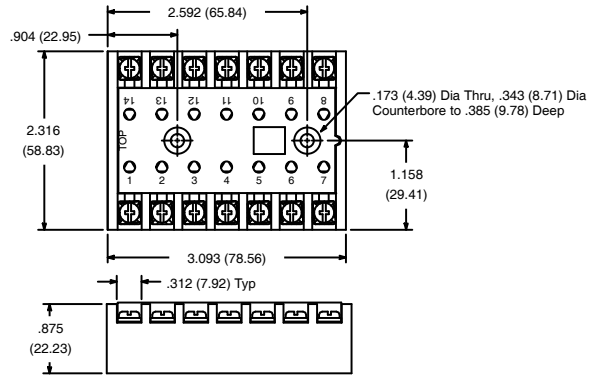
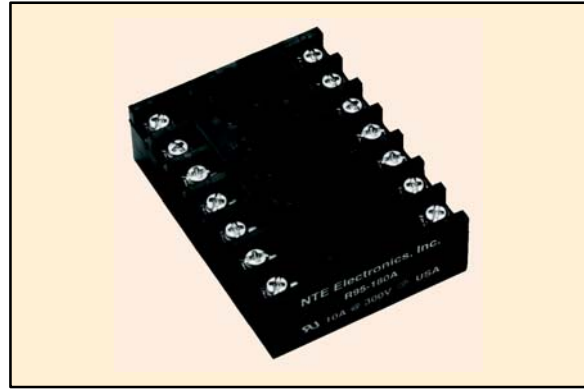

R95-181

8-Pin Octal Socket

Features

- DIN Rail Mount
- Finger Safe
- DPDT Applications

Electrical Rating:

300 Volts (UL Rating for US), 10 Amps

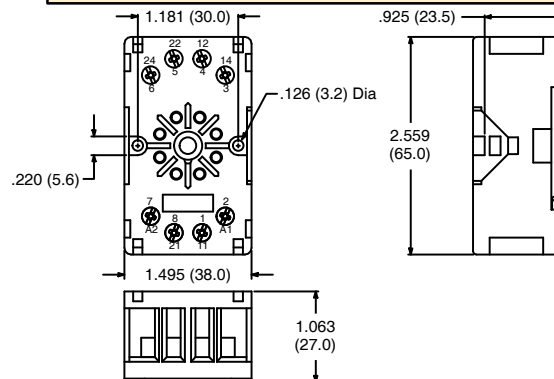

R95-182

11-Pin Octal Socket

Features

- DIN Rail Mount
- Finger Safe
- 3PDT Applications

Electrical Rating:

300 Volts (UL Rating for US), 10 Amps

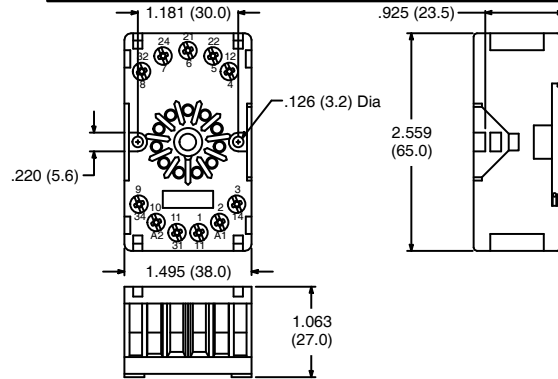

R95-184

Dust Cover, Plastic

Features

- Clear Polycarbonate
- For RS3 Type Relays

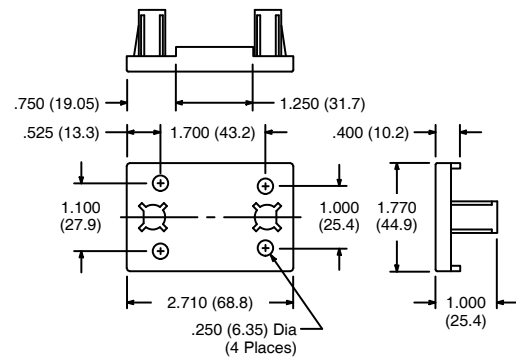
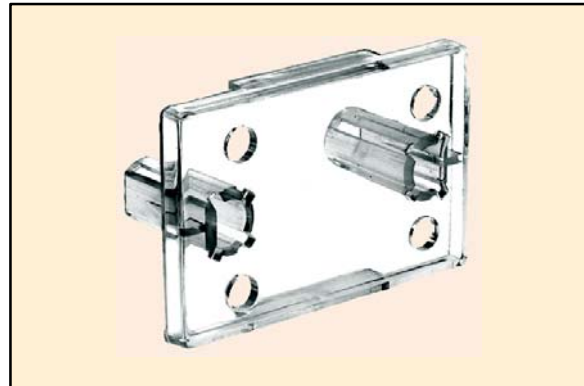

R95-117



14-Pin Miniature Socket

Features

- Panel Mount
- DIN Rail Mountable
- Pressure Clamp Screws
- DPDT or 4PDT
- Hold down clip not supplied with socket, available separately (R95-001)

Electrical Rating:

300 Volts, 10 Amps

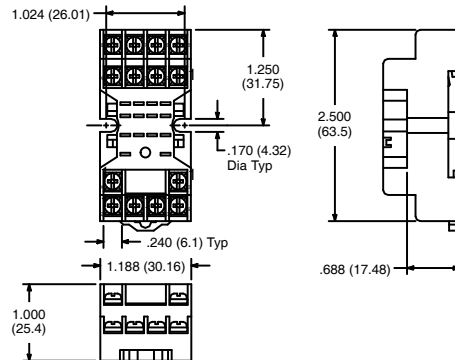
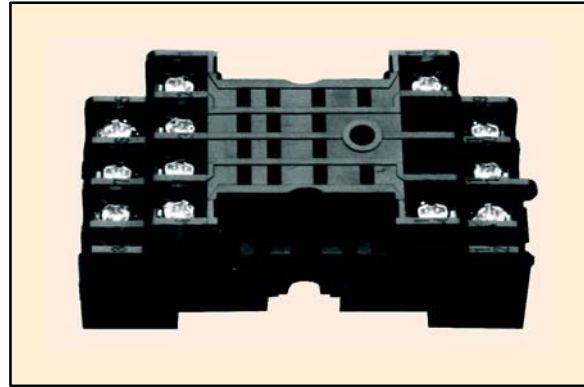

R95-118

8-Pin Octal Socket

Features

- Panel Mount
- Solder Terminals

Electrical Rating:

300 Volts, 10 Amps

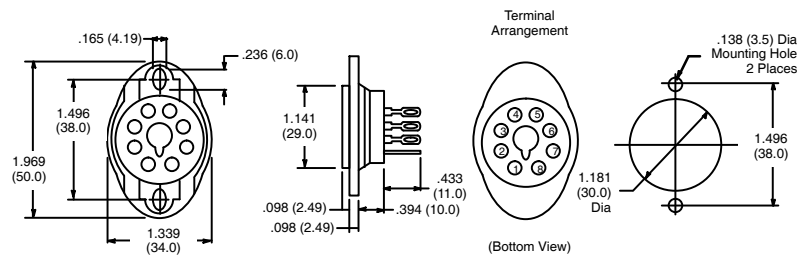

R95-119

11-Pin Octal Socket

Features

- Panel Mount
- Solder Terminals

Electrical Rating:

300 Volts, 10 Amps

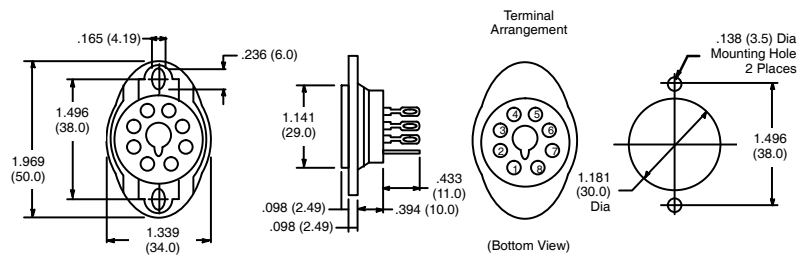

R95-120



8-Pin Midget Blade Socket

Features

- P.C. Board Mount
- Accepts .187" Blade Terminals
- Hold down clip not supplied with socket, available separately (R95-001)

Electrical Rating:

300 Volts, 10 Amps

